

British Standard Taper Locks

12B-1-2-3 Taper Lock

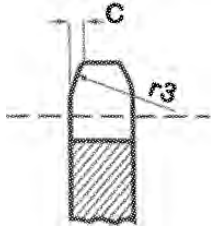

Teeth	de	dp	dm	A	Bush	Type	App. Kg	dm	A	Bush	Type	App. Kg	dm	A	Bush	Type	App. Kg		
13	87.8	79.59	60	25.40	1210	1	0.41												
14	93.6	85.61	70	25.40	1610	1	0A												
15	99.8	91.63	70	25.40	1610	1	0.54	-	30.10	1610	0A	0.90	-	49.8	1615	5	0A		
16	105.5	97.65	75	25.40	1610	1	0A	-	30.10	1610	0A	0A							
17	111.9	103.7	76	25.40	1610	1	0.82	-	30.10	1610	0A	1.25	-	49.8	1615	5	0A		
18	117.9	109.7	90	31.75	2012	1	0.91	90	31.75	2012	0A	0A							
19	123.9	115.8	90	31.75	2012	1	1.00	90	31.75	2012	0A	1.81	-	49.8	2012	5	0A		
20	130	121.8	90	44.45	2517	1	1.00	108	44.45	2517	0A	0A							
21	136	127.8	102	44.45	2517	1	1.18	108	44.45	2517	0A	2.50	-	49.8	2517	5	0A		
22	142	133.9	102	44.45	2517	1	1.27	108	44.45	2517	0A	0A							
Pinions	mm	23	148.1	139.9	108	44.45	2517	1	1.37	108	44.45	2517	0A	3.07	-	49.8	2517	5	0A
Tooth Radius r3		24	154.1	145.9	108	44.45	2517	1	1.50	108	44.45	2517	0A	0A					
Radius Width C		25	160.2	152	108	44.45	2517	1	1.74	108	44.45	2517	0A	3.63	-	49.8	2417	5	0A
Tooth Width B1	11.1	26	165.9	158	108	44.45	2517	1	0A	108	44.45	2517	0A	0A					
		27	172.3	164.1	108	44.45	2517	1	1.80	108	44.45	2517	0A	4.20	140	50.80	3020	4	0A
Chain	mm	28	178	170	108	44.45	2517	1	0A	108	44.45	2517	0A	0A					
Pitch	19.05	29	0A	0A	0A	0A	0A	0A	0A	0A	0A	0A	0A						
Inside	11.68	30	190.4	182.3	108	44.45	2517	1	2.32	140	50.80	3020	0A	5.04	140	50.80	3020	4	0A
Roller ø	12.07	32	202.5	194.4	108	44.45	2517	1	2.48										
		34	0A	0A	0A	0A	0A	0A	0A										
		38	238.9	230.1	108	44.45	2517	1	3.36	140	50.80	3020	0A	8.40	140	50.80	3020	4	0A
		45	283.2	273.1	108	44.45	2517	1	3.98										
		57	355.9	345.8	124	44.45	2517	1	8.76	0A	50.80	3020	0A	19.48	160	50.80	3020	4	0A
		76	471.1	461	124	44.45	2517	1	11.68	0A	50.80	3020	0A	29.52	160	50.80	3020	4	0A
		95	586.2	576.2	0A	44.45	2517	1	14.60	0A	50.80	3020	0A	34.40					
		114	701.4	691.4	0A	44.45	3020	1	17.52	0A	76.20	3030	0A	39.28					

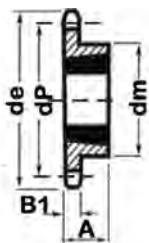

Type 1

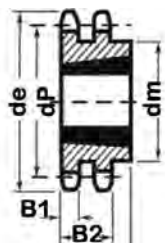

Type 2

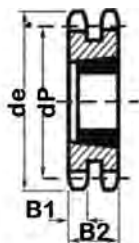

Type 3

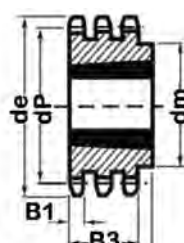

Type 4

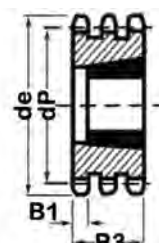

Type 5